



## DESCRIPTION



Capacity: 10 x 60x40 - GN 1/1



Trays insertion: Crosswise



Dimensions: 920 x 862 x H 1133 mm



Control panel: Programmable



Indicative quantity of meals: 100



Cooking chamber heating: Gas



Steam generation: direct system

## COOKING MODES AND FUNCTIONING

	<b>Convection mode</b>	Temperature range between 50 °C and 270 °C
	<b>Convection with steam</b>	Adjustable steam quantity
	<b>Automatic programs</b>	99 Automatic programs (3 phases + preheating)
	<b>Autoreverse</b>	Automatic reversal of fan rotation

## CONTROL PANEL COMPONENT DESCRIPTION

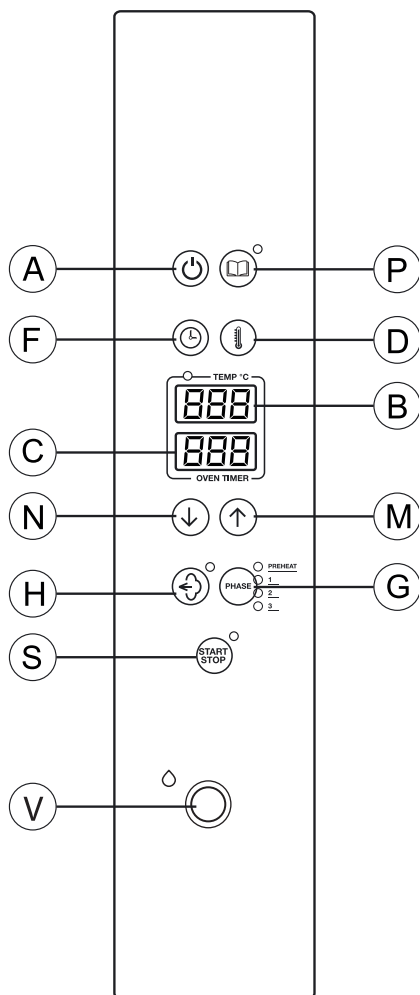

<b>A</b>	ON/OFF button
<b>B</b>	Temperature display
<b>C</b>	Time display
<b>D</b>	Cooking chamber temperature selection
<b>F</b>	Time selection
<b>G</b>	Program's phases
<b>H</b>	Steam quantity selection
<b>M</b>	Increase value button
<b>N</b>	Reduce value button
<b>P</b>	Automatic programs
<b>S</b>	Start/stop button
<b>V</b>	Release valve opening

## MANUFACTURING FEATURES

- Heating system located on the back side of the cooking chamber;
- Waterproof cooking chamber in stainless steel AISI 304;
- Cooking chamber with external welding;
- External covering panels made of satin stainless steel AISI 430;
- Base chassis made of stainless steel AISI 430;
- Cooking chamber gas heating system;
- Thermal insulation of the cooking chamber in ceramics fibre;
- Cooking chamber fans made of stainless steel;

**OPTIONAL ACCESSORIES**

Code	Description
KDLA	Hand shower
SO-NEQ70	Stand H 70 cm
SR-NEQ70	Stand with shelf

Code	Description
RT-NEQ70	Tray slides
SOT-NEQ70	Stand with tray-slides
SRT-NEQ70	Stand with shelf and tray-slides

**DIMENSIONS**

	OVEN	PACKAGE
Width	920 mm	960 mm
Depth (with door handle)	862 mm	960 mm
Height	1133 mm	1320 mm
Weight/Volume	135 kg / 1.22 m <sup>3</sup>	

**WATER SUPPLY**

Water supply coupling	Ø ¾" gas
Water pressure	1.5 - 2.5 bar
Water hardness	4 - 12 °f = 40 - 120 ppm
Water conductivity	50 ÷ 2000 µS/cm
Chlorine concentr. Cl <sub>2</sub>	< 0.2 mg/litre
Chloride concentration	<150 mg/litre
Water drain coupling	Ø 40 mm

**POWER SUPPLY**

Model	EQ-SPG910-HS
Power loading	0.4 kW
Chamber power	--
Power of the motors	n° 3 x 120 W
Max. power loading	0.6 kW
Voltage	220 - 240 V 1N ~ 50 Hz
Absorbed current	1.6 A
Feed cable section	n° 3 x 1.5 mm <sup>2</sup>
Capacity	10 x 60x40 - GN 1/1
Pitch between trays	75 mm

**GAS SUPPLY**

Suitable system for gas	Natural	G20
	Butane	G30
	Propane	G31
Gas supply coupling	Ø ½" gas	
Power loading	20,0 kW	
Cooking chamber power	20,0 kW	

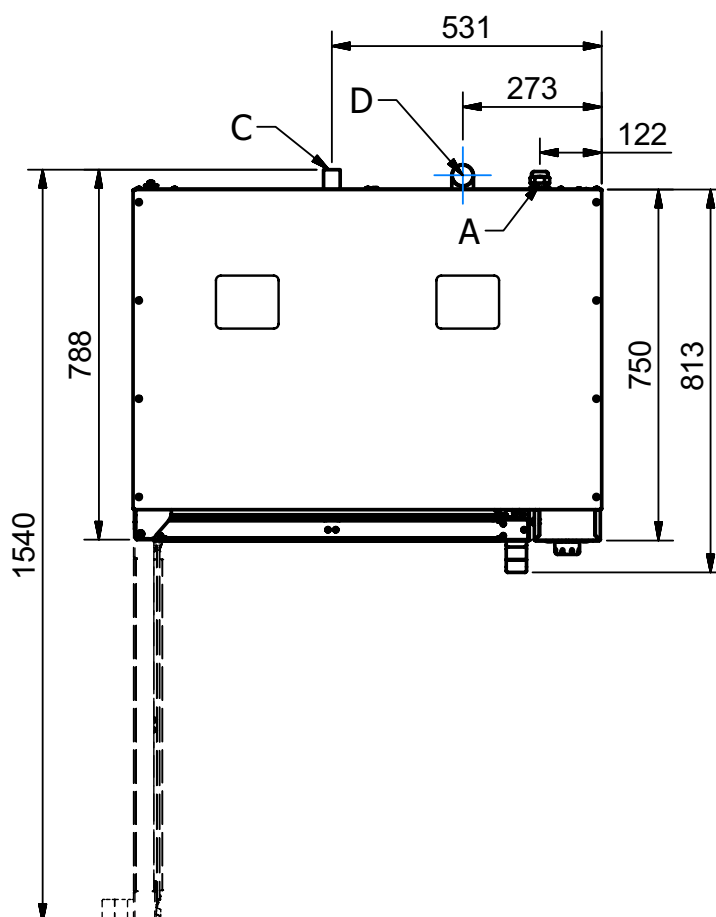
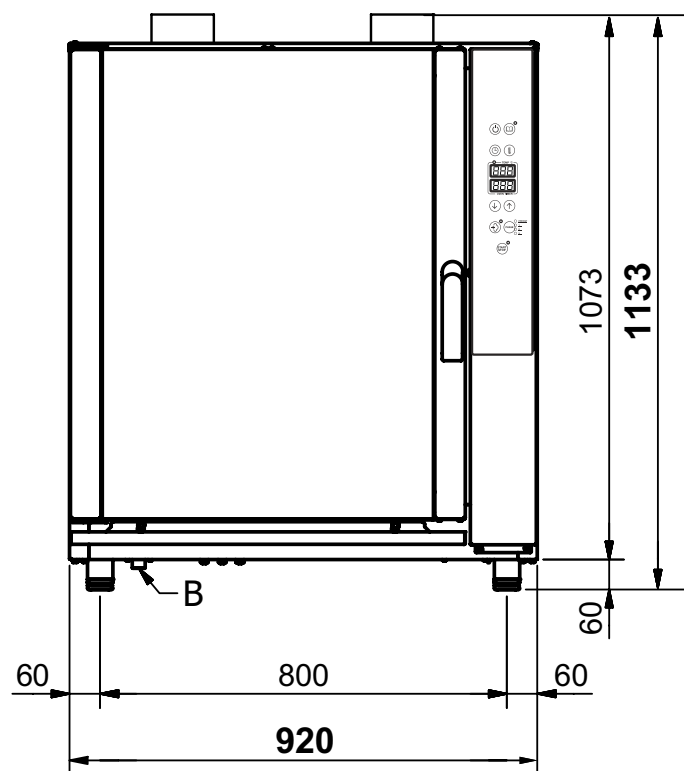
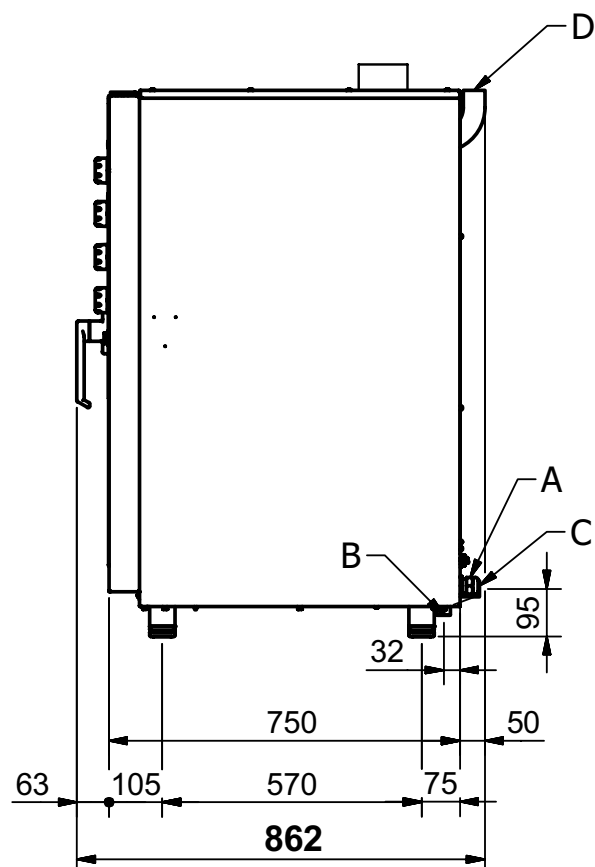

- A Electrical cables connection  
B Water inlet Ø 3/4" gas  
C Chamber drainage Øe 40 mm  
D Cooking chamber release valve